

Drill stand KF 600

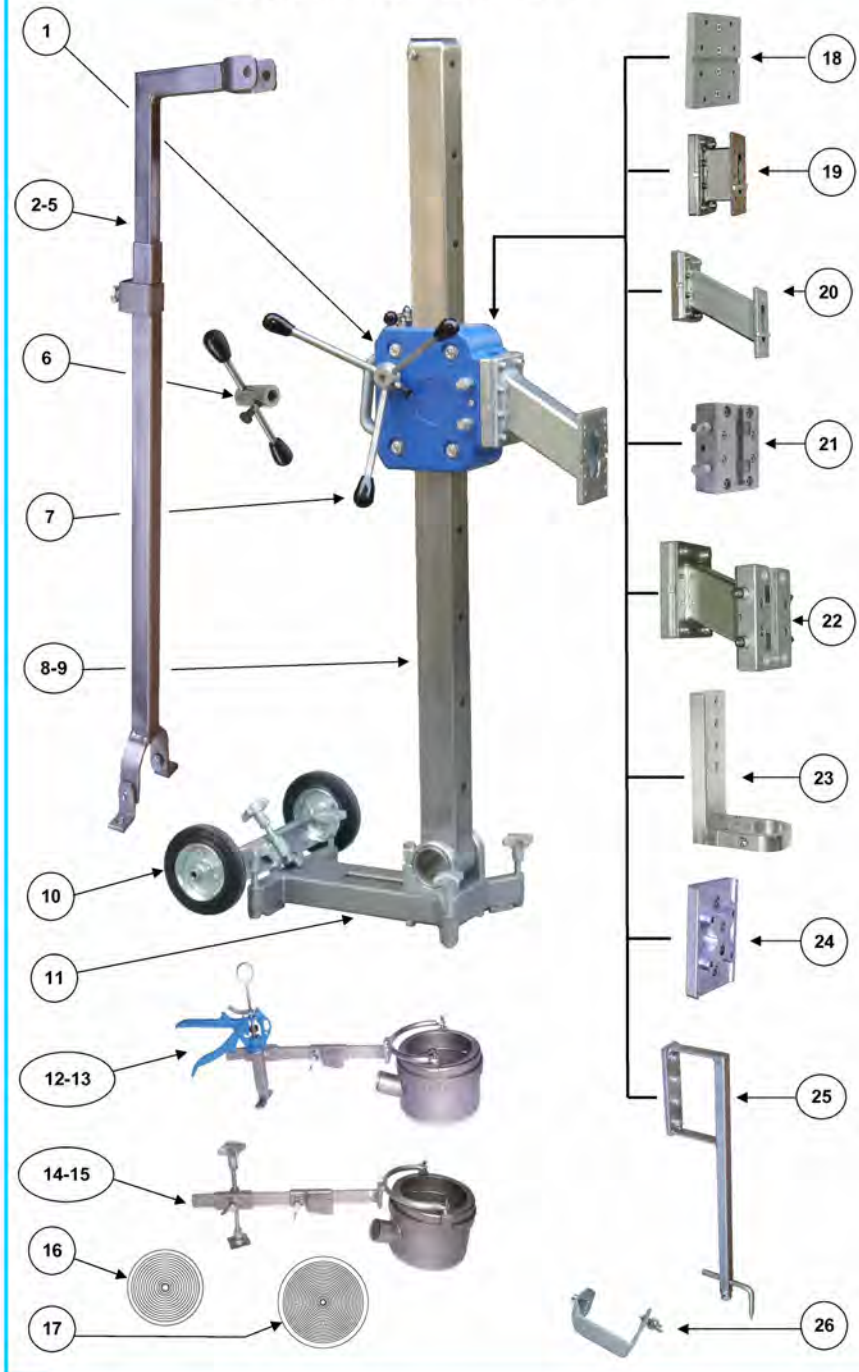

components and parts list KF 600

Item	Designation	Order no.	Piece
1	Carriage with colour cpl.	601.1.0 KF	1
2	Support 1400 mm cpl.	400.19.00 K	1
3	Support 2000 mm cpl.	400.20.00 K	1
4	Support 1400 mm for retrofiting	400.22.00 K	1
5	Support 2000 mm for retrofiting	400.23.00 K	1
6	Spring lever crank cpl.	600.3.0 K	1
7	Crank cpl.	250.2.0 K	1
8	Column 1400 mm with flexible bracket cpl.	600.6.014 G.K	1
9	Column 2000 mm with flexible bracket cpl.	600.6.020 G.K	1
10	Wheel Kit cpl.	600.1.06 K	1
11	Foot plate steel cpl.	600.4.0 ST.K	1
12	Drill water scution ring+chuck handle D132 cpl.	250.8.0 K	1
13	Drill water scution ring+chuck handle D202 cpl.	250.9.0 K	1
14	Drill water suction ring+chuck screw D132 cpl.	250.8.01 K	1
15	Drill water suction ring+chuck screw D202 cpl.	250.9.01 K	1
16	Membrane D 132	150.8.7	1
17	Membrane D 202	250.8.7	1
18	Drilling motor plate cpl.	600.1.18 K	1
19	Spacer 110 mm cpl.	400.2.0 BD K	1
20	Spacer 190 mm cpl.	600.2.0 BD K	1
21	Quick change distance piece 50 mm cpl.	600.1.19 BG K	1
22	Quick change distance piece 170 mm cpl.	600.2.01 BDG K	1
23	Instep neck adapter cpl.	150.11.0 K	1
24	Motor plate for Hilti Engines cpl.	400.1.18 H K	1
25	Drilling middles indicator, m.d. 115-150 mm cpl.	250.10.2 K	1
26	End stop cpl.	250.6.30 K	1

Technical data KF 600:

Max. bore diameter	600 mm
Slide feed travel	1090 mm
Weight	37 kg
Dimensions (height) mm	1540
Max. motor output	5,3 KW
Gear ratio	1:20

More information is available at: www.flei-ka.de

Visit us also: www.facebook.com/fleikasoyen